

Specifications

Nominal Voltage (V) 12V

Nominal Capacity

20 hour rate	(0.9A to 10.50V)	18Ah
10 hour rate	(1.8A to 10.50V)	17.1Ah
5 hour rate	(3.06A to 10.20V)	15.3Ah
1 C	(18A to 9.60V)	8.1Ah
3 C	(54A to 9.60V)	6.3Ah

Weight Approx. 6.306kg (13.87 Lbs.)

Internal Resistance (at 1KHz) Approx. 10 mΩ

Maximum Discharge Current for

5 seconds: 327A

Charging Methods at 25°C (77°F)

Cycle use:

Charging Voltage 14.4 to 15.0V

Coefficient -5.0mv/°C/cell

Maximum Charging Current: 5.4A

Standby use:

Float Charging Voltage 13.50 to 13.80V

Coefficient -3.0mv/°C/cell

Operating Temperature Range

Charge 0°C (32°F) to 40 °C (104°F)

Discharge -15°C (5°F) to 50 °C (122°F)

Storage -15°C (5°F) to 40 °C (104°F)

Charge Retention (shelf life) at 20°C (68°F)

1 month 92%

3 month 90%

6 month 80%

Case Material ABS UL94HB

(Option: ABS UL94 V-0 flame retardant)

Terminal

F3

ENERGY SAFE

Dimensions

mm (inch)

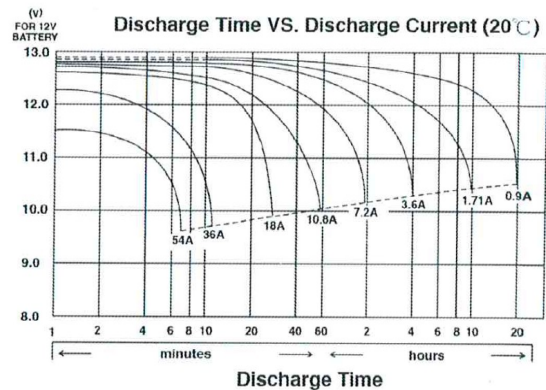
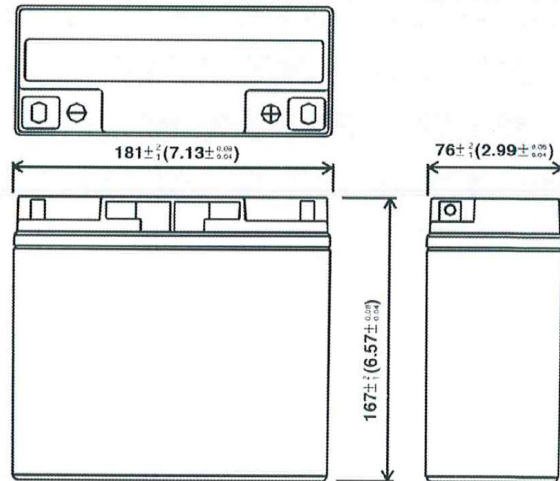
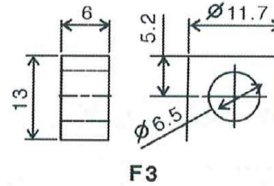

PERFORMANCE DATA

Discharge Rates in Watts to Various End Voltages at 25°C (77°F)

Time	End Voltage	11.10V	10.80V	10.50V	10.20V	9.90V	9.60V
5	min	712	733	748	785	799	819
10	min	425	472	503	521	528	538
15	min	333	366	388	401	406	413
30	min	188	204	214	220	222	225
60	min	108	116	120	123	124	125
120	min	75.1	78.8	81.1	82.4	82.8	83.3
180	min	48.0	49.9	51.1	51.7	51.9	52.1
240	min	39.2	40.5	41.3	41.7	41.8	41.9
300	min	34.0	35.0	35.6	35.8	35.9	36.0
600	min	20.3	20.6	20.7	20.8	20.8	20.9
1200	min	10.0	10.1	10.4	10.4	10.5	10.5

Discharge Rates in Amperes to Various End Voltages at 25°C (77°F)

Time	End Voltage	11.10V	10.80V	10.50V	10.20V	9.90V	9.60V
5	min	61.9	63.7	65.0	68.2	69.5	71.2
10	min	37.0	41.0	43.7	45.3	45.9	46.8
15	min	29.0	31.9	33.8	34.9	35.3	35.9
30	min	16.4	17.7	18.6	19.1	19.3	19.5
60	min	9.43	10.1	10.4	10.7	10.8	10.9
120	min	6.53	6.85	7.05	7.17	7.20	7.25
180	min	4.17	4.34	4.44	4.50	4.51	4.53
240	min	3.41	3.52	3.59	3.63	3.64	3.65
300	min	2.96	3.04	3.09	3.12	3.12	3.13
600	min	1.77	1.79	1.80	1.81	1.81	1.82
1200	min	0.87	0.88	0.90	0.90	0.91	0.91